



- Extra reinforced steel cast body through the heat treatment and industrial design.
- Light and robust design.
- 100% Holding negative-acting hydraulic brake system.
- Standard pressure roller and roller fairlead.
- Easy assembly, high rope capacity and high torque hydromotor.
- Standard manual rope unloading system.
- CE Machinery Directive 2006/42/EC
- Meets SAE J706 rating

## Specifications

<b>Max. pulling capacity (lbs / kg)</b>	: 13500 lbs ( 6125 kg )
<b>Max. rope length (m / ft)</b>	: 31 m ( 101 ft )
<b>Recommended wire rope (mm / in)</b>	: 14 mm (5/9") 1960 Mpa
<b>Hydromotor (cc / in<sup>3</sup>)</b>	: 400 cc ( 24 in <sup>3</sup> )
<b>Max. pump flow (L / min - g / min)</b>	: 60 L/min ( 15.8 g/min )
<b>Gear ratio</b>	: 5,2 : 1
<b>Oil types and capacity</b>	: 85W 90 - 0,9 L
<b>Max. working pressure (bar / psi)</b>	: 175 bar (2538 psi)

Rope Winding Layer	Pulling Capacity kg / lbs	Rope Speed m / min - ft / min	Rope Length m / ft
1	6125 kg / 13500 lbs	10.3 m/min - 33.8 ft/min	6.2 m / 20 ft
2	5093 kg / 11226 lbs	12.4 m/min - 40.6 ft/min	13 m / 43 ft
3	4359 kg / 9608 lbs	14.5 m/min - 47.5 ft/min	21.7 m / 71 ft
4	3810 kg / 8397 lbs	16.5 m/min - 54.4 ft/min	31 m / 101 ft

## Winch : (kg / lbs )

90 kg (198.4 lbs)

## Roller Fairlead : ( kg / lbs )

9 kg ( lbs)

## Cable Tensioner ( kg / lbs)

4 kg (9 lbs)

## Mounting Bolts

16 pieces M12

## Standards

Cable tensioner  
Roller Fairlead  
Manual Clutch

## Optional

Air Clutch  
IP67 - IP 68

## Hydraulic Inlets

G 1/2"

## Warning !

- Before operating the winch, A-B lines must be open to T line (tank line) of the control valve in center position.
- This winch is designed and manufactured for pulling, don't lift person or material.
- Always keep last 5 wrap on the drum.
- The technical details given above are just for information.
- HAMMER WINCH keeps the right to change the technical details.
- Pneumatic working pressure: Min 9 bar - Max 12 bar (Min 130psi - Max 174 psi)

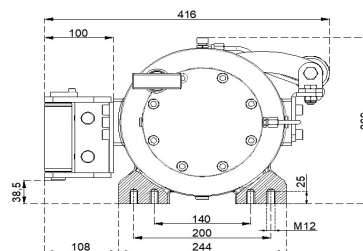
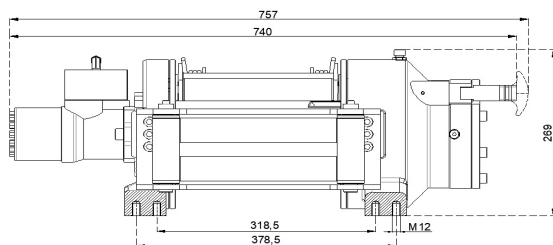

Manual Clutch

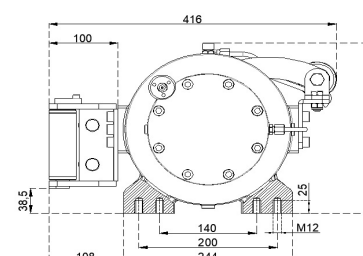
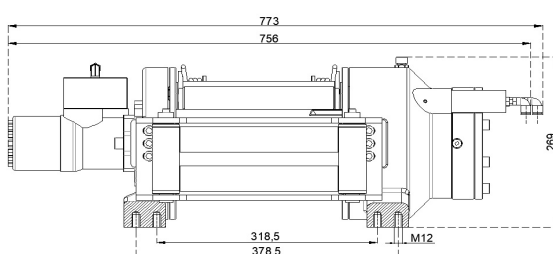
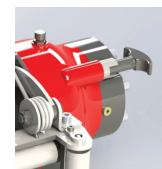

Air Clutch

